

## Newport 250E

Area: 298 m<sup>2</sup> (32.08 sq)

Minimum width of site required  
15.06m. Conditions apply.

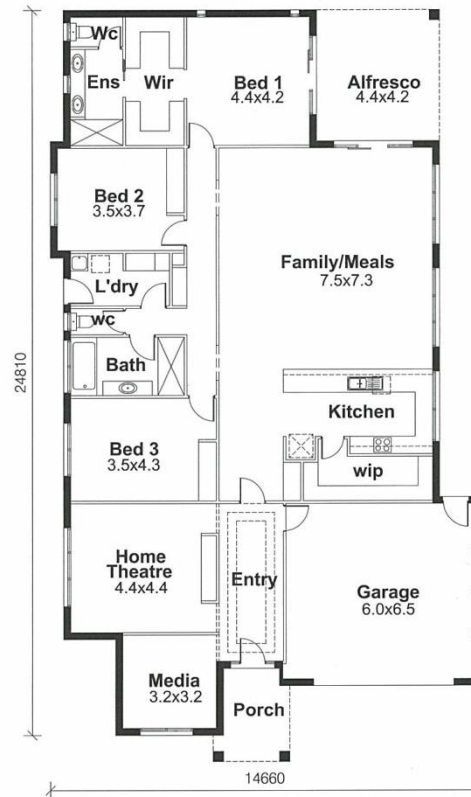

## Newport 270E

Area: 317 m<sup>2</sup> (34.12 sq)

Minimum width of site required  
16.01m. Conditions apply.

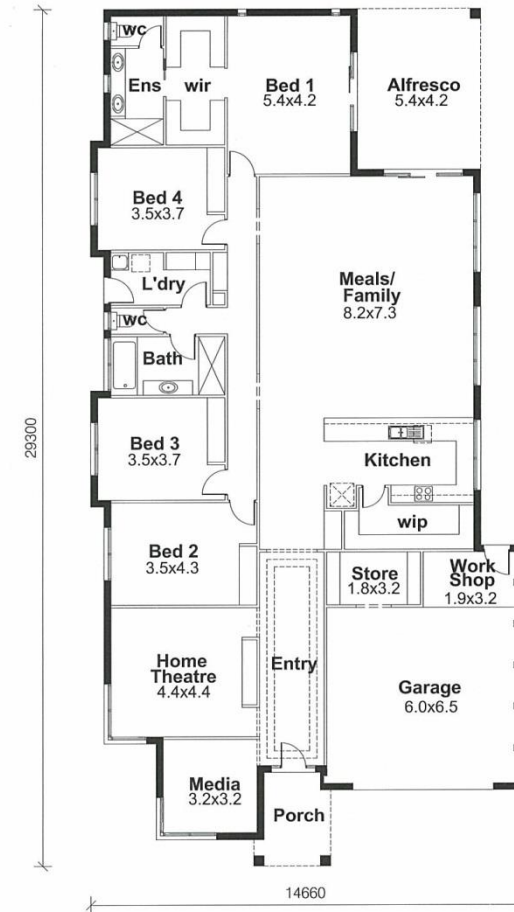

## Newport 310E

Area: 367 m<sup>2</sup> (39.50 sq)

Minimum width of site required  
16.01m. Conditions apply.